

INSTALLATION

5

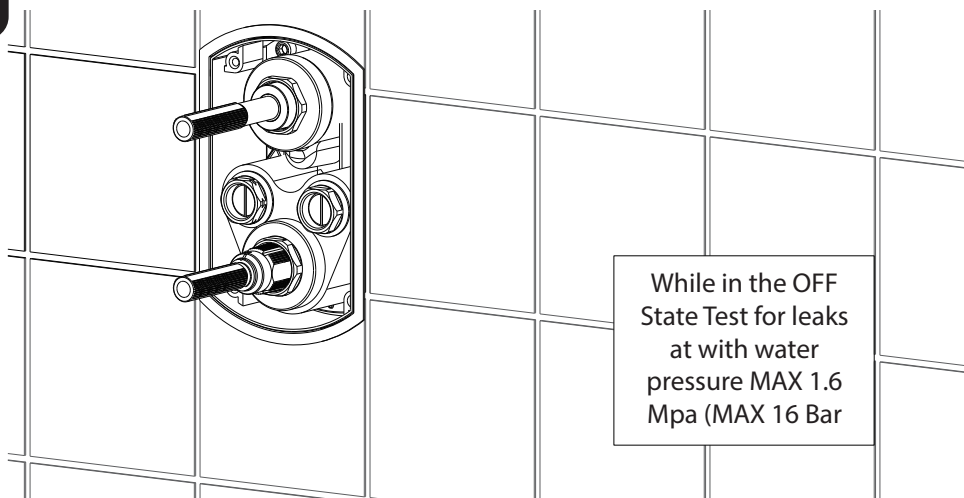

6

Plastic connection should be trimmed to 50.5mm max

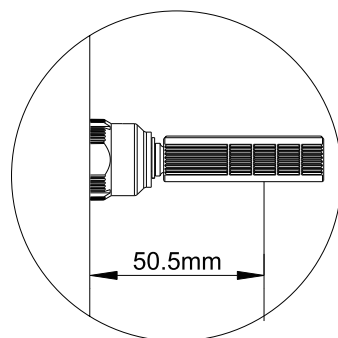

AFTER SALES & TECHNICAL SUPPORT

Our highly experienced after sales and technical support team are always on hand to help should you require technical advice or a spare part.

T: +44 (0)28 3025 9988

E: technical@mylifebathrooms.com

Universal Concealed Valve Thermostatic Mixer Valve & Diverter Installation Manual

THIS PRODUCT MUST BE INSTALLED
BY A LICENSED PLUMBER



MYLIFE®

PRE-INSTALLATION CHECKS

- Please read installation instructions fully before commencing installation.
- Check that the product is compatible with your current requirements.
- Before installation, please make sure you have received all items and that they are undamaged. Any damage claims after installation will not be accepted.
- Please check for any hidden pipes and cables, electric or otherwise before drilling holes in a wall.
- Turn off the main water supply before connecting to any existing pipe work.

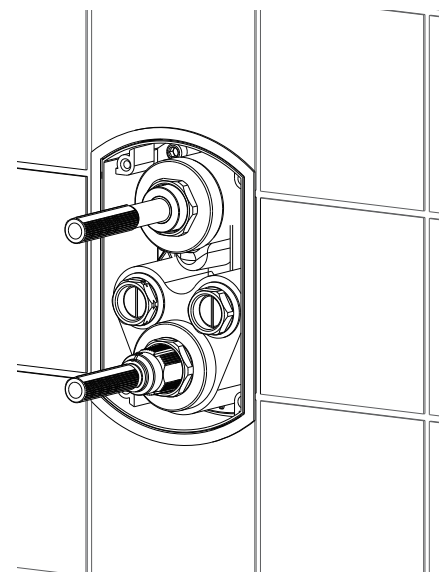

CARE INSTRUCTION

- During installation, extra care must be taken to avoid damaging the fitting or it's finish.
- This product is finished to a high standard. To keep the product surface in pristine condition, clean with a soft damp cloth only. To avoid limescale / watermarks from building up, it is advisable to wipe the fitting dry each time it is used.
- Damage to the surface caused by improper cleaning/maintenance will not be covered under guarantee.
- On no account should any bathroom cleaner be used on this product as these can contain acids that are aggressive/corrosive on finished surfaces! Do not use abrasive sponges, scouring agents, organic solvents or acidic cleaners as they may cause surface deterioration.

INSTALLATION

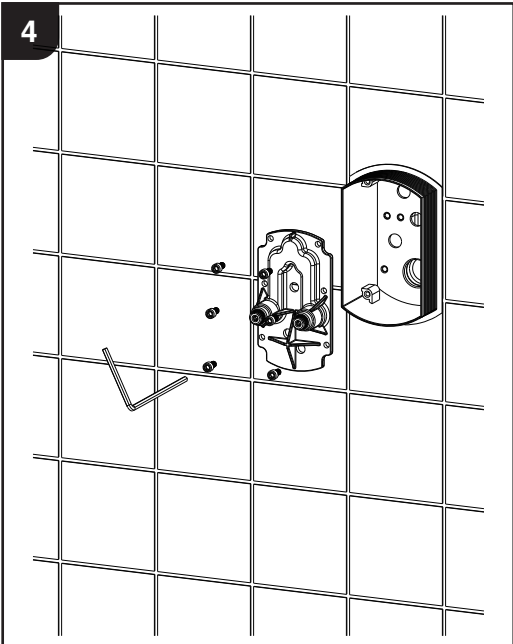
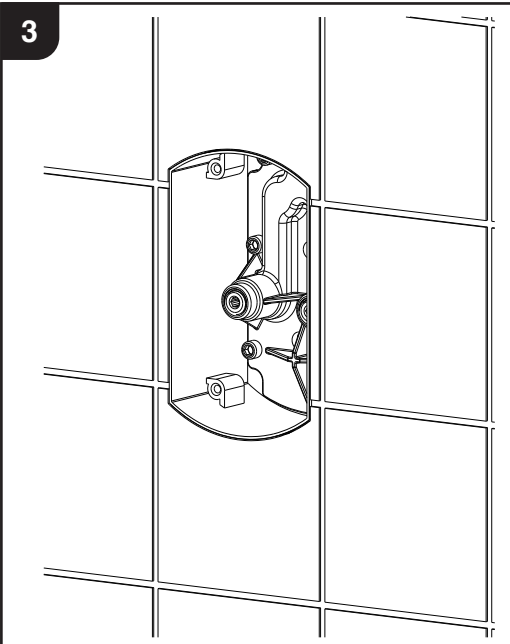
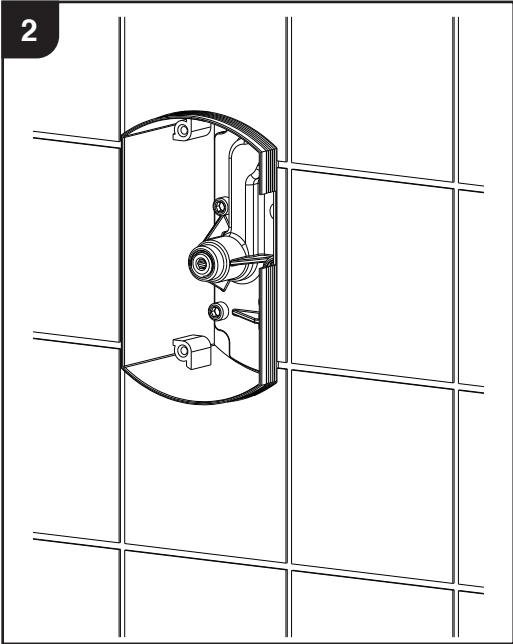
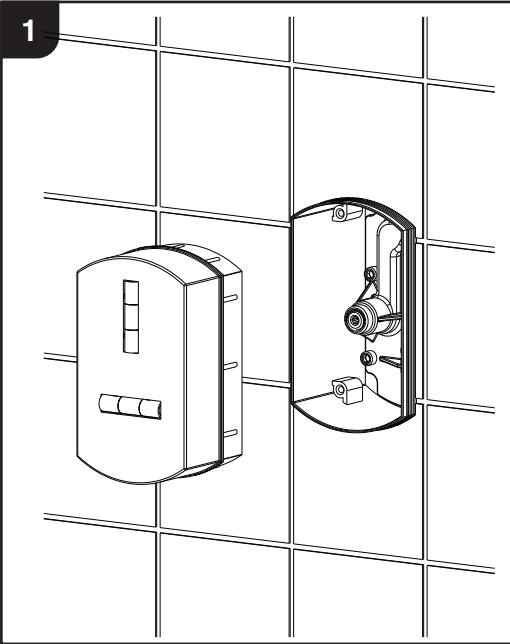

INSTALLATION

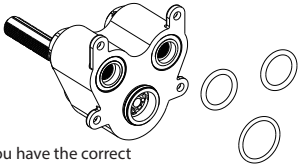
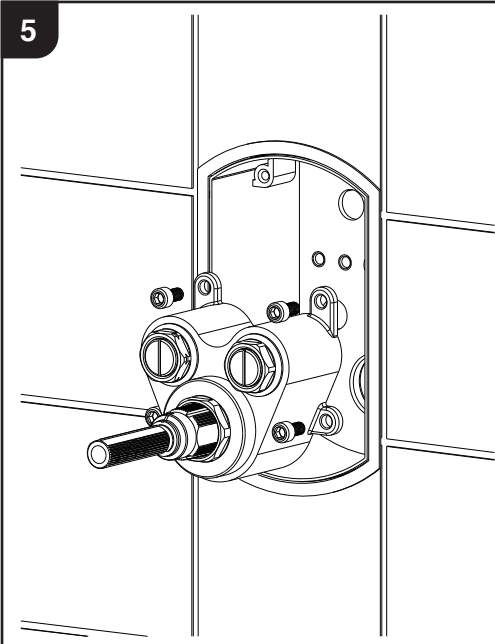

Check you have the correct number of O-Rings before installation

Inlet pipe OFF state - connection is fully home

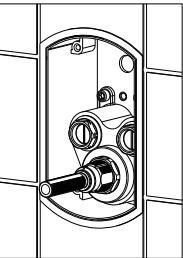

Inlet pipe ON state - connection is level to the shell

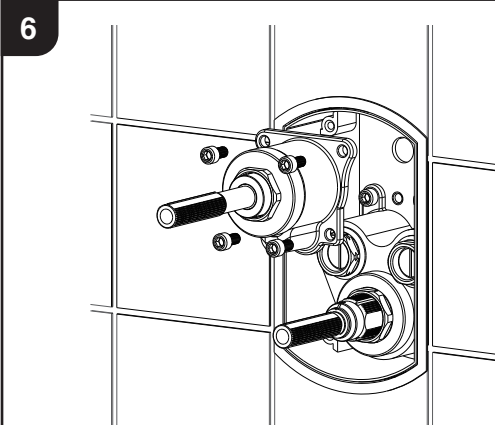

**ATTENTION
INSTALLER**

WARNING
If the O-Rings aren't installed correctly the valve will leak

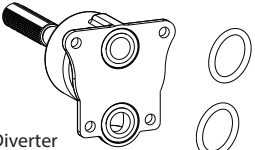

1 Outlet Diverter

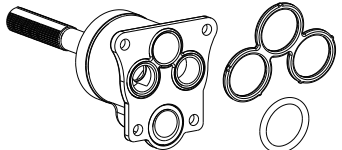

2 Outlet Diverter

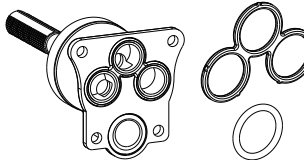

3 Outlet Diverter